

**BATEMANS BAY BUSHWALKERS INC.** 2011. 380  
**WALK PROPOSAL FORM**

Walks Organiser: Bob Thurbon, 38 Dell Parade  
 Moruya S Head 2537 Tel 4474 4170  
 Assistant:

Please complete form with as much detail as possible and pass it to the Walks Organiser or the Assistant Walks Organiser by due date shown on Program.  
 Please use black pen/ biro, otherwise it doesn't photocopy well. Thank You.

PROPOSED DATE/S SUNDAY 29th MAY 2011 DATE LAST WALKED / NEW WALK

NAME OF WALK BIG LOCK ROAD CIRCUIT

MAP/S (eg. Kioloa) New Series (GDA94) BODALLA + NAROOMA or Old Series (AGD66)

GRID REFERENCE (Start) 354 992 (Finish) 354/992 CAR SHUFFLE? Yes /  No

WALK LEADER/S KAREN COCKERILL Telephone 4471-1636

**Note:** It is compulsory to carry a BBBW GPS (or your own) and spare batteries on all BBBW walks  
 Do you wish to be issued with a BBBW GPS for this walk? Yes /  No

**WALK GRADING: Please ✓**

- EASY  Good tracks, relatively flat terrain
- EASY/MEDIUM  Good tracks, some hills or more difficult sections
- MEDIUM  Rougher tracks, fairly steep hills
- MEDIUM/HARD  Rough tracks, steep hills, possibly rock scrambling & creek crossings
- HARD  Up to 8 hrs, rough terrain, possibility no tracks; for fit & capable walkers
- EXPLORATORY  Walks in terrain unfamiliar to leader, fit & capable walkers only

**NATURE OF TERRAIN: Please ✓**

- GOOD WALKING TRACK  G
- HILLY  H
- ROUGH TRACK  RT
- NO TRACK  NT
- CREEK CROSSING  CkX
- ROCK SCRAMBLING  RS
- BEACH WALKING  BW

WALK TIME 3 hrs TOTAL TIME 5 hrs WALK DISTANCE 10 kms DRIVE 126 kms  
 (return from BB)

ASSEMBLY POINT & DEPARTURE TIMES: BATEMANS BAY (CP) 9.00 hrs Will you be at CP?  Yes / No

MOGO \_\_\_\_\_ hrs MORUYA (CPM) 9.30 hrs Degree of Difficulty 16

OTHER MEETING PLACE V+1=C at \_\_\_\_\_ hrs

ADDITIONAL (eg. Barbecue, Swimming, etc) AFTERNOON TEA AT BODALLA

BR&F

**ROUGH MAP OF ROUTE** (either attach a photocopy to scale of the map with route marked; or draw a facsimile of the route in the space below; or give a description of walk using grid references, eg. (Kioloa map) START at 573674 (18 Mile Peg Rd) Walk east to 582672 (road junction on right) turn south – follow road to 489663 take left fork to 586669 etc.)  
 LIST ANY STATE FORESTS TRAVERSED. BODALLA SF

**Walks Organiser's Use Only**

DATE ALLOCATED 29/5/11 WALK NO. 11-38-M-16+18

WALK APPROVED [Signature] PASSENGER CONTRIBUTION BB \$ 3.00 Other \$ 4.00  
 (Walks Organiser)

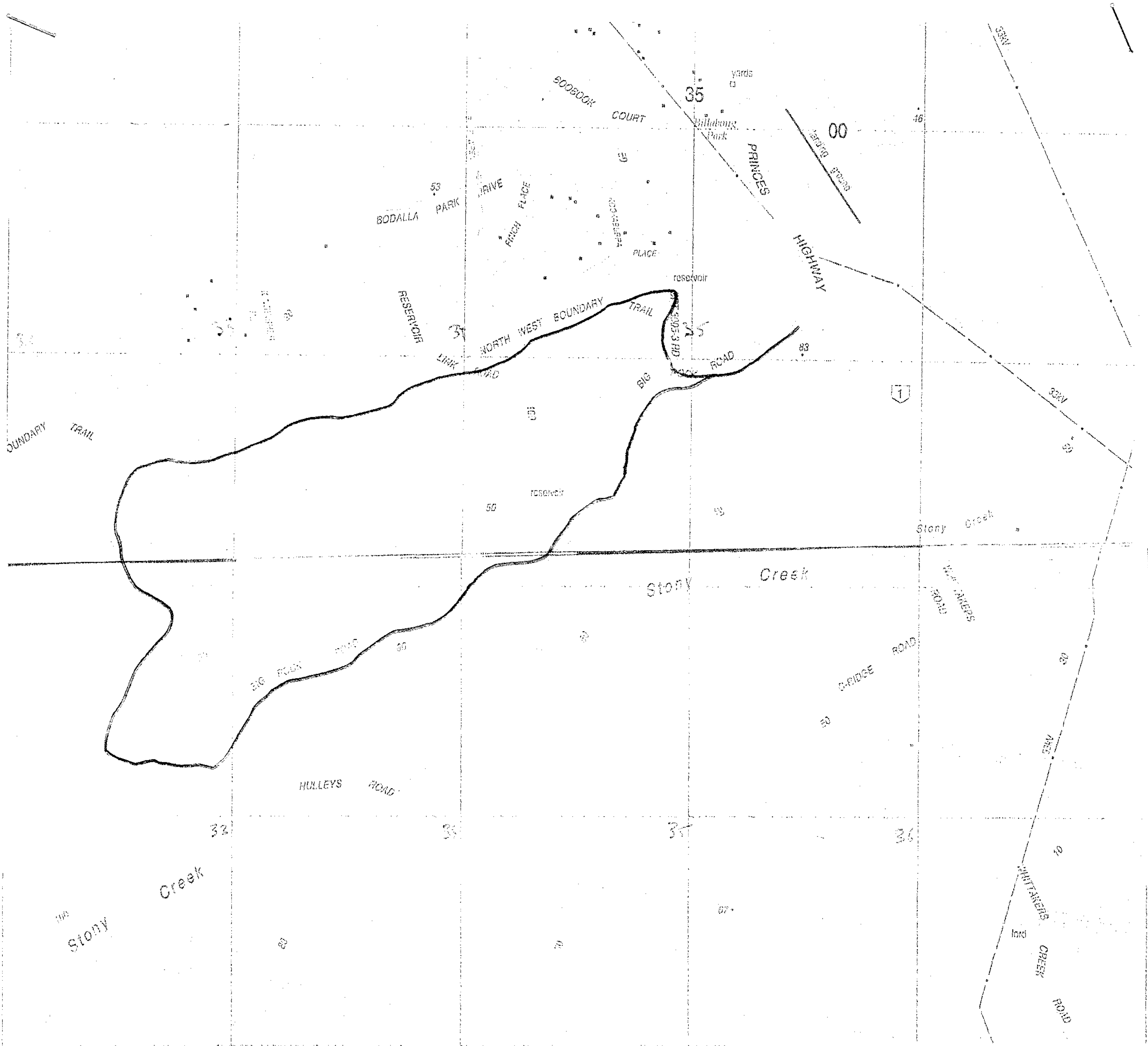

- Anything else you think we should know? (private property access, great views, historic interest, unusual vegetation, recently been logged, recently been burned, etc.)

Thank You

